

TECHNIKA PRO

IDTV User Guide



Model No **19-218**
 22-218



Important Guarantee Information.

Congratulations on purchasing this television. We hope you have many years of trouble free enjoyment from your purchase.

Your product is covered under the manufacturers guarantee for 12 months from date of purchase.

In the event of a fault being diagnosed, please refer to the frequently asked questions/troubleshooting section at the rear of this user guide.

If you are still unable to remedy the fault, try resetting the TV to factory settings, (details in this user guide) or contact the helpline.

In the event that a fault is diagnosed, the helpline will arrange to collect the TV from your home or work address, return it to our service centre, repair the item and then return it to you.

If we believe we cannot offer a permanent repair, we will replace the item.

Sky Media UK LTD – Helpline Information

Telephone UK **0871 2000 463** ROI **01443 3940**

Email: **service@skymediauk.co.uk**

Internet: **www.skymediauk.co.uk**

The telephone opening hours are Monday to Friday 8.30am to 6pm, Saturday 9am – 5pm.

On the web site, you can register your product and guarantee, if you do it within 7 days of purchase, you will also receive an extra **FREE** 3 months warranty, making the warranty 15 months from date of purchase.

You must retain all packaging materials as you will need these in the event of warranty/service support.

If you need to call the helpline, you will need the following information.

Model Number _____ (Can be found on the front of this user guide)

Serial Number _____ (Can be found on rear of TV)

Date of purchase _____ (Can be found on sales receipt)



Keep this important information about how to re-tune your TV during the digital TV switchover

When does switchover happen?

The exact date you switch depends on the transmitter you are served by. To check when you switch, go to Digital UK's postcode checker on www.digitaluk.co.uk Check your ITV news service or look at Teletext page 106 to see what TV region you're in.



Important information regarding the digital TV switchover

Television in the UK is going digital, bringing us all more choice and new services. Starting late 2007 and ending in 2012, television services in the UK will go completely digital, TV region by TV region.

How the switchover affects your TV equipment.

Your new TV has a digital tuner built in, which means it is ready to receive the Freeview signal by simply connecting it into your aerial socket (you can check if you can get digital TV through your aerial now or whether you will have to wait until the switchover at www.digitaluk.co.uk)

When the TV switchover happens in your area, there are at least two occasions when you will need to re-tune your TV in order to continue receiving your existing TV channels and also to pick up new ones. Digital UK, the body leading the digital switchover, will advise you when you need to retune during the switchover.

How to retune.

Retuning your TV is a very quick and simple process. We recommend that you retune every few months to ensure you are receiving the very latest TV and radio channels that are broadcast.

- In digital/freeview mode, on the remote control press 'LCD menu' quickly followed by 8-8-8-8 (so press the number 8 four times)
- You will now enter the 'First time installation' mode. (if you do not, please refer to the section called 'getting started' later in this user guide)

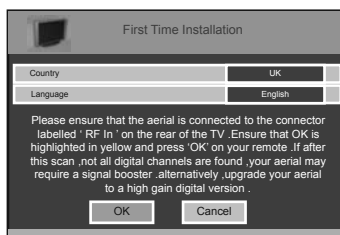

- Simply press 'OK' or 'Enter' on the remote control and your TV will retune.

If you do not retune your TV when advised to do so by Digital UK, you may lose some or all of your channels until you do re-tune.

If you are missing any channels, it may be that they are not available in your area, or that your TV aerial needs upgrading.

For help and support regarding the digital switchover, please contact Digital UK:

Telephone: 08456 50 50 50

Digital UK website: www.digitaluk.co.uk

If you require technical or warranty support on this television, please contact the manufacturer helpline, do not contact Digital UK unless your query is regarding the digital switchover.

Warnings

Caution

This television contains no user serviceable parts. Please refer to the manufacturer or authorised repair agent in the event of malfunction. Do not remove the back cover from the television.

Warning

To reduce the risk of fire, electric shock or damage to the television, do not expose it to dust, rain or moisture, or place any objects filled with liquids on or near the television.

Do not place the television in a confined space, ensure that nothing can obstruct the ventilation openings at the rear of the television.

Do not place naked flames on or near the television.

Dispose of this television and any components including batteries in an environmentally friendly manner. If in doubt, please contact your local authority for details of recycling.

Your LCD TV should be cleaned using a dry or slightly damp cloth. You should not use an alcohol based cleaner

Safety

For your safety, this appliance is fitted with a fused moulded 3 pin mains plug. Should the fuse need to be replaced, ensure that any replacement is of the same amperage and approved with the BSI mark. (🔌)

Never try and replace the mains plug unless you have adequate qualifications and are legally authorised to do so. In the event that a replacement Mains cable is required, contact the manufacturer for a suitable replacement.

Never use the television if it is damaged in any way.

Always place the television on a flat level surface avoiding anywhere which may be subject to strong vibration. Ensure the television is not placed on top of the power cable as the weight of the television may damage the cable and cause a safety hazard.

Never place mobile phones, speakers or any other device which may cause magnetic or radio interference with the television. If interference is apparent, move the device causing the interference away from the television.

Warnings

Screen Burn

A characteristic of LCD TV Panels is that displaying the same image for a long time may cause a permanent after - image to remain on the screen. This is called screen burn. Most pictures shown on your TV will be constantly moving and fill the screen.

Examples of images that you need to watch out for are as follows (this is not an all-inclusive list):

- **TV Channel Logos:** e.g. Shopping channel logos and pricing displays-especially if they are bright and stationary. Moving or low-contrast graphics are less likely to cause ageing of the screen.
- **Time Displays**
- **Teletext:** Do not view a stationary page for long periods of time.
- **TV/DVD Menus:** e.g. Listings of DVD disk content.
- **Pause Mode:** Do not leave the TV in pause mode for long periods of time, e.g. When watching DVDs or videos.

Note: To prevent screen burn, if viewing any of the above for long periods of time, reduce contrast and brightness when viewing. Once burn-in occurs it will never disappear completely.

How do I dispose of this product?

UK: Waste electrical products should not be disposed of with household waste. Separate disposal facilities exist. For your nearest facilities, please see www.recycle-more.co.uk or instore for details.

ROI: Produced after 13th August 2005. Waste electrical products should not be disposed of with household waste. Please recycle where facilities exist. Check with your Local Authority or retailer for recycling advice.



Safety Warnings

Introducing the LCD TV

Installing the LCD TV

Using The Features

Troubleshooting

Specifications

Safety Warnings

Introducing the LCD TV

Installing the LCD TV

Using The Features

Troubleshooting

Specifications

Contents

■ Chapter 1 Introducing the LCD TV	
Getting Started	8 - 9
■ Chapter 2 Installing the LCD TV	
Remote Control Buttons	10
TV Buttons	11
Source Menu	11
Inputs & Connections	12
■ Chapter 3 Using The Features	
Picture Menu	13 - 16
Sound Menu	17 - 18
Tuning Menu	19 - 20
Timer Menu	21
General Menu	22 - 23
7 day TV Guide	24
Digital Text	25
Analogue TV Text	26
iPod Operation	27 - 30
Connecting to a PC	31 - 32
VGA (PC) Menu	33 - 34
DVD Menu	35 - 38
Wall Mounting	39
Using with Sky Digital	40 - 41
Connecting a Games Console	42
■ Troubleshooting	
Frequently Asked Questuions	43
■ Specifications	
Technical Specification	44
Index	45

If you experience any problems with this Television,
Please contact the helpline.

Customer Support/Technical Helpline
Sky Media UK LTD
Telephone UK 0871 2000 463
ROI 01443 3940
Email: service@skymediauk.co.uk

Safety Warnings

Introducing the LCD TV

Installing the LCD TV

Using The Features

Troubleshooting

Specifications

What is included in the box

Accessories

Included with this TV are the following accessories:

1x - User Guide Book



1x - Remote control



1x - RF lead



2x - AAA batteries



1x - Quick Start Guide

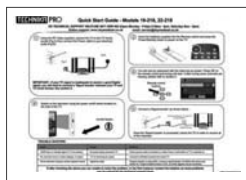

1x - TV

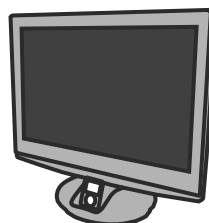

1x - AC Mains lead



4 x iPod Dock inserts to hold your iPod safely in the iPod dock



Getting Started - Initial Set Up

IMPORTANT - AFTER TUNING DO NOT PRESS ANY BUTTONS FOR 20 SECONDS SO THE CHANNEL INFORMATION CAN BE STORED.

TUNING IN

1) Using the RF Cable supplied, connect the TV to the TV Aerial socket (Fig A)

IMPORTANT: If your TV signal is inadequate to receive a good Digital signal, you will need to connect a 'Signal booster' between your TV and TV Aerial Socket. See section 5.



It is highly unlikely you will receive any/all of the digital channels using an indoor/portable TV aerial. You should use a Digital/Hi Gain outdoor aerial for optimum signal reception.

- 2) Connect the Power cable to your electrical outlet and the Television (Fig B above)
- 3) Switch on the television using the power switch located next to the DVD player
- 4) Insert the batteries supplied in the Remote control and press the Power/Standby button to power on the TV



You will now be welcomed with the initial set-up screen. Follow the on screen instructions:

- 5) A) Select country - default is UK
- B) Select language - default is English
- C) Ensure TV aerial is connected and press OK on the remote control to Tune in the Television

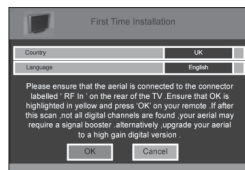

5) If the TV finds some but not all of the Digital channels the TV is **functioning correctly** but the signal being received is not strong enough. (The signal strength needs to be above 85% - you can see the signal strength the TV is receiving when you change channels/ programmes) you will need to increase the signal strength in order to receive all of the channels available. The most economical way to do this is by purchasing and connecting a 'signal booster' in between the TV and the TV aerial socket. If this does not solve the problem, you will need to upgrade the TV aerial to a digital hi-gain compatible aerial

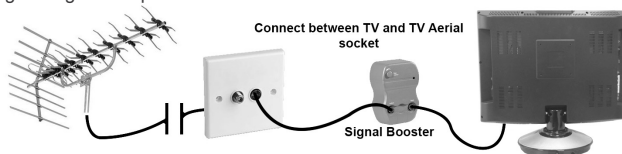

Once you have connected a 'Signal booster' you will need to retune the TV in order to receive all of the channels.

Safety Warnings

Introducing the LCD TV

Installing the LCD TV

Using The Features

Troubleshooting

Specifications

Remote Control Buttons

Safety Warnings

Introducing the LCD TV

Installing the LCD TV

Using The Features

Troubleshooting

Specifications

1

Power
Press to switch on LCD when in standby mode or vice versa

2

Mute
Press to mute the sound and press again to restore

3

ATV
Press to change to analogue TV mode

4

DVB
Press to change to digital TV/Freeview mode

5

DVD
Press to change to DVD mode

6

iPOD
Press to change to iPod mode

7

NUMBER BUTTONS
Press 0 – 9 to select a TV channel directly when you are watching TV. The channel will change after 2 seconds.

8

Return
Return to the previous channel viewed

9

TEXT

Teletext mode: Press to enter the teletext

DVD/iPOD mode: Press to play or pause

10

HOLD

Teletext mode: Press hold on or off for current page display

DVD/iPOD mode: Press to replay the current action from the previous chapter/track

11

REVEAL

Teletext mode: Press to reveal or hide the hidden words

DVD/iPOD mode: Press to advance forward to the next chapter/track

INDEX / GO TO

Teletext mode: Press to request the index page

DVD mode: Press to Go To a specific chapter on a DVD

12

SIZE

Teletext mode: Press to change the display size

13

SUBPAGE

Teletext mode: Press to enter sub coded page access

DVD/iPOD mode: Press to play a DVD programme or iPod track in fast rewind mode

14

Fast Forward

DVD/iPOD mode: Press to play a DVD programme or iPod track in fast forward mode

15

Play/Pause

DVD/iPOD mode: Press to play or pause the DVD or iPod playing

16

FAV / D.TITLE

Digital mode: Press to display favourite menu

DVD mode: Press to display the disc menu (if available on DVD disc)

17

FAV- / D.MENU

Digital mode: Press to decrease favourite channel

DVD mode: Press to display the disc menu (if available on DVD disc)

18

FAV+ / ZOOM

Digital mode: Press to increase favourite channel

DVD mode: Press to select the zoom to change picture size

19

NICAM

Digital mode: Press to select NICAM

DVD mode: Press to eject disc

20

SUBTITLE / SUBT.

Press to switch between the different subtitle languages



DVB-LANGUAGE / AUDIO

Digital mode: Press to select the digital language

DVD mode: Press to select DVD audio channels

GUIDE/REPEAT

Digital Mode: Press to show the TV Guide menu

DVD Mode: Press to set repeat

INFO/A-B

Digital Mode: Press to display channel information and help information in TV Guide

DVD Mode: Press to A-B playback

3

NAVIGATION BUTTONS

Allows you to navigate the on-screen menus and adjust the system settings to your preference

MENU

Press to display OSD menu

EXIT

Press to exit OSD menu

4

SOURCE

Press to open the source menu

DISPLAY

Press to display the source and channel's information

IPOD MODE: Press to show software version

IPOD MENU

Press to open the iPod OSD menu

PC-AUTO

Press to automatically set up the screen in PC mode

CH+

Press to increase the channel by one

CH-

Press to decrease the channel by one

VOL+

Press to increase the volume

VOL-

Press to decrease the volume

LIST

Press to open the OSD track and song information in iPod mode

ASPECT

Switches the TV between the different picture formats

SLEEP

Activates the sleep mode

5

P.MODE

Press repeatedly to cycle through the available video picture modes

BASS-

Press to decrease the sub bass

BASS+

Press to increase the sub bass

S.MODE

Press to cycle through the different sound modes

ANGLE

Press to select different angle of DVD when available on disc

INTRO

Press to play a short introduction to each chapter when available on disc

COLOUR BUTTONS

For operating digital and analogue teletext

TV Buttons

TOP PANEL BUTTONS

1	DVD - Eject
2	DVD - Play/Pause
3	Select the input source
4	Displays Menu/OSD
5	Volume down and menu left
6	Volume up and menu right
7	Programme/Channel down and menu down
8	Programme/Channel up and menu up
9	Standby ON/OFF

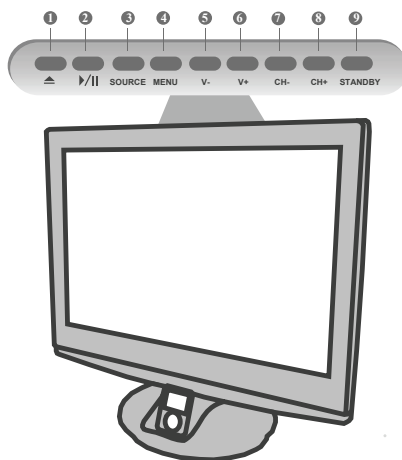

SIDE PANEL

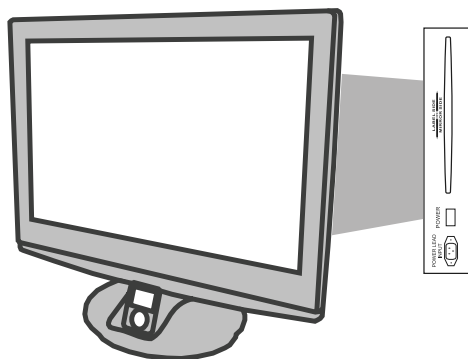

Choosing Mode/Source

To switch between the different connections is very easy.

Using the buttons on the remote control:

- 1) Press [SOURCE] - The following will appear
- 2) Press [V] or [^] to select the input you require.
- 3) Press [OK]

Using the buttons on the Television:

- 1) Press [SOURCE]
- 2) Scroll up/down using CH+/CH- buttons to the input/source you require
- 3) Press Vol+ to change input/source to the one selected

SOURCE MENU

TV/ANALOGUE
DIGITAL/FREEVIEW
IPOD
HDMI
SCART
YPBPR/COMPONENT
VIDEO
VGA/PC
DVD

Scroll $\uparrow\downarrow$ on the required input source and press OK

Safety Warnings

Introducing the LCD TV

Installing the LCD TV

Using The Features

Troubleshooting

Specifications

Inputs & Connections

REAR CONNECTIONS

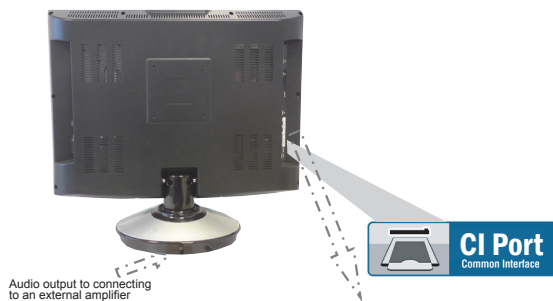

A	COAX Audio Out	Digital Audio Out (DVD)
B	RF IN	RF input
C	VGA/PC Audio In	PC Audio input
D	YPbPr/Video Audio In	Video/Component Audio input
E	COMPONENT	Component input
F	VIDEO	Video input
G	SCART	Scart input
H	VGA(PC)	VGA-PC input
I	HDMI	HDMI input



CONNECTING A DVD RECORDER OR VIDEO RECORDER

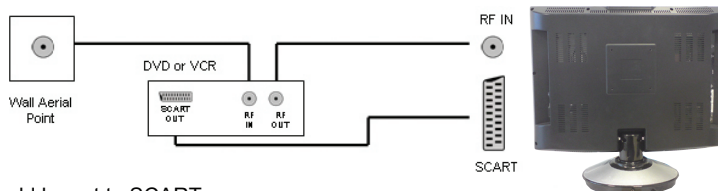

Source should be set to SCART

CONNECTING A HIGH DEFINITION DEVICE

OPTION A – HDMI

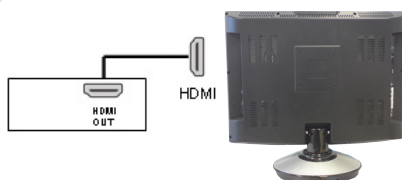

Source should be set to HDMI

OPTION B – COMPONENT & AUDIO CABLES

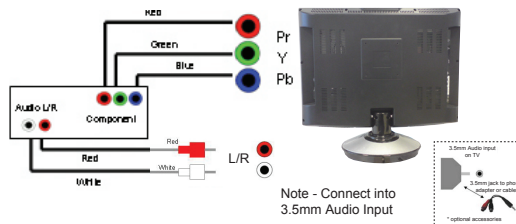

Source should be set to YPbPr/COMPONENT

CONNECTING A CAMERA OR CAMCORDER

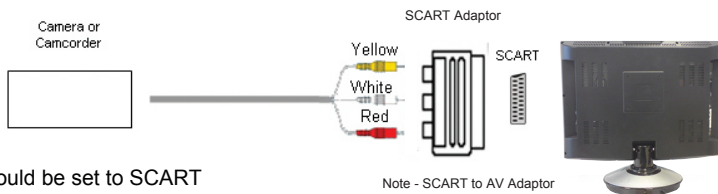

Source should be set to SCART

Note - SCART to AV Adaptor – often included with some devices, alternatively, these can be purchased from the helpline/website

TV Menu Operation

PICTURE SETTINGS MENU

Lets you adjust picture mode, contrast, brightness, colour, tint and sharpness to enhance the viewing experience.

PLEASE NOTE – YOU CAN ONLY MAKE ADJUSTMENTS TO CONTRAST, BRIGHTNESS & COLOUR WHEN PICTURE MODE IS SET TO 'PERSONAL'.

Selecting Picture Mode Presets

Switch between different preset picture options

Standard	All settings are set to 50
Personal	Lets you manually alter all the settings
Movie	Set to enhance when watching a movie
Sport	Set to enhance when watching a sport
Mild	Set to be lighter in colour and less bright
Game	Set to enhance when playing a games console

- 1) Press [MENU] to enter menu
- 2) Press [V] to highlight Picture Mode
- 3) Press [>] to navigate through the various options



- 4) Press [EXIT] to exit

Adjusting Contrast (Only available when Picture Mode is set to Personal)

Switch the balance between black and white

- 1) Press [MENU] to enter menu
- 2) Press [V] to highlight Contrast
- 3) Press [>] to increase the contrast or [<] to decrease the contrast

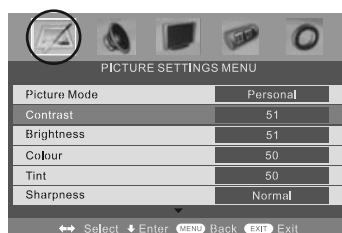

- 4) Press [EXIT] to exit

Safety Warnings

Introducing the LCD TV

Installing the LCD TV

Using The Features

Troubleshooting

Specifications

TV Menu Operation

PICTURE SETTINGS MENU

Adjusting Brightness (Only available when Picture Mode is set to Personal)
Increase or decrease the brightness of the picture

- 1) Press [MENU] to enter menu
- 2) Press [V] to highlight Brightness
- 3) Press [>] to increase the brightness or [<] to decrease the brightness

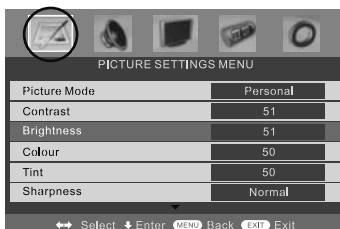

- 4) Press [EXIT] to exit

Adjusting Colour (Only available when Picture Mode is set to Personal)
Increase the colour from black and white to vivid

- 1) Press [MENU] to enter menu
- 2) Press [V] to highlight Colour
- 3) Press [>] to increase the colour or [<] to decrease the colour

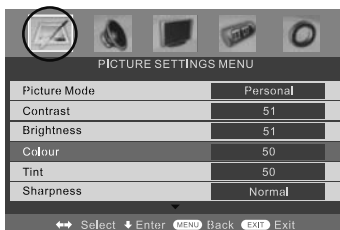

- 4) Press [EXIT] to exit

TV Menu Operation

PICTURE SETTINGS MENU

Adjusting Tint (only available in VGA/PC Mode)

Lets you increase or decrease the level of tint within the picture

- 1) Press [MENU] to enter menu
- 2) Press [V] to highlight Tint
- 3) Press [>] to increase the tint or [<] to decrease the tint

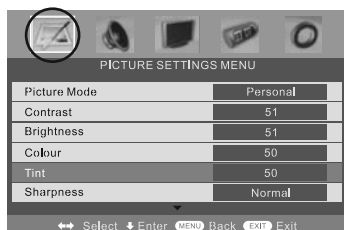

- 4) Press [EXIT] to exit

Adjusting Sharpness

You can change the sharpness between the different preset options

Normal	For standard use
Sharp	For pictures with little movement
Sharpest	For pictures with nearly no movement
Soft	For pictures with large amount of movement
Softest	For pictures with lots of movement

- 1) Press [MENU] to enter menu
- 2) Press [V] to highlight Sharpness
- 3) Press [>] to navigate through the various options



- 4) Press [EXIT] to exit

Safety Warnings

Introducing the LCD TV

Installing the LCD TV

Using The Features

Troubleshooting

Specifications

TV Menu Operation

PICTURE SETTINGS MENU

Colour Temperature (Only available in VGA/PC Mode)

There are 3 presets for colour temperature

Normal	Standard setting
Warm	Increased red within the picture
Cold	Increased blue within the picture

- 1) Press [MENU] to enter menu
- 2) Press [V] to highlight Colour Temperature
- 3) Press [➤] to navigate through the various options

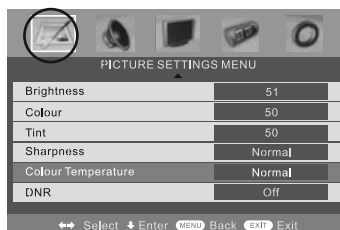

- 4) Press [EXIT] to exit

Dynamic Noise Reduction

Reduces the interference in the picture.

- 1) Press [MENU] to enter menu
- 2) Press [V] to highlight DNR
- 3) Press [➤] to switch between OFF, LOW, MILD and HIGH.

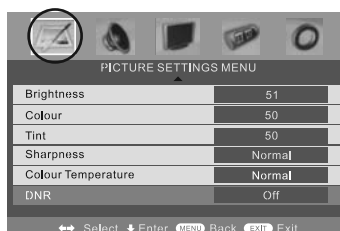

- 4) Press [EXIT] to exit

TV Menu Operation

SOUND SETTINGS MENU

Adjusting Volume

Lets you adjust the volume of the television

- 1) Press [MENU] to enter menu
- 2) Press [>] to move to Sound Settings Menu
- 3) Press [V] to highlight Volume
- 4) Press [>] to increase the volume or [<] to decrease the volume

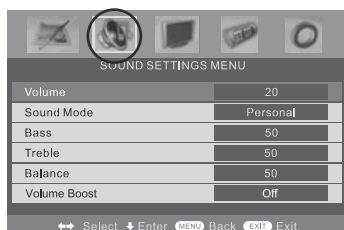

- 5) Press [EXIT] to exit

Selecting Sound Mode

Switch between different preset sound options

Voice	Emphasises voice over other sounds
Music	Emphasises music over voices
Theatre	Provides livelier and full sound for movies
Personal	Selects your personal sound settings

- 1) Press [MENU] to enter menu
- 2) Press [>] to move to Sound Settings Menu
- 3) Press [V] to highlight Sound Mode
- 4) Press [>] to navigate through the various options



- 5) Press [EXIT] to exit

Safety Warnings

Introducing the LCD TV

Installing the LCD TV

Using The Features

Troubleshooting

Specifications

TV Menu Operation

SOUND SETTINGS MENU

Adjusting Bass

To adjust the amount of bass within the sound

- 1) Press [MENU] to enter menu
- 2) Press [>] to move to Sound Settings Menu
- 3) Press [V] to highlight Bass
- 4) Press [>] to increase the bass or [<] to decrease the bass



- 5) Press [EXIT] to exit

Adjusting Treble

To adjust the amount of treble within the sound

- 1) Press [MENU] to enter menu
- 2) Press [>] to move to Sound Settings Menu
- 3) Press [V] to highlight Treble
- 4) Press [>] to increase the treble or [<] to decrease the treble



- 5) Press [EXIT] to exit

Adjusting Balance

To switch the sound between the left and right speakers

- 1) Press [MENU] to enter menu
- 2) Press [>] to move to Sound Settings Menu
- 3) Press [V] to highlight Balance
- 4) Press [>] to increase the balance or [<] to decrease the balance



- 5) Press [EXIT] to exit

Volume Boost

This is to boost the volume level in all modes (except iPod Mode) to bring to a higher level.

- 1) Press [MENU] to enter menu
- 2) Press [>] to move to Sound Settings Menu
- 3) Press [V] to highlight Volume Boost
- 4) Press [>] to switch ON or OFF



- 5) Press [EXIT] to exit

TV Menu Operation

TUNING SETTINGS MENU (Only Freeview & Analogue TV modes)

Adjusting Country

If you are moving country you may wish to change the Country Settings

- 1) Press [MENU] to enter menu
- 2) Press [>] to move to Tuning Settings Menu
- 3) Press [V] to highlight Country
- 4) Press [>] to alter the chosen country



- 5) Press [EXIT] to exit

Auto Tuning

Scan for all channels based on the current settings

- 1) Press [MENU] to enter menu
- 2) Press [>] to move to Tuning Settings Menu
- 3) Press [V] to highlight Auto Tuning



- 4) Press [>] to enter Auto tuning
- 5) Press [OK] to start the tuning
- 6) Press [EXIT] to exit

Manual Tuning

You may wish to manual search if you can't find a certain channel or if you wish to connect to a Satellite/Cable box via RF/Aerial connector

- 1) Press [MENU] to enter menu
- 2) Press [>] to move to Tuning Settings Menu
- 3) Press [V] to highlight Manual Tuning
- 4) Press [>] to enter manual tuning
- 4) Press [>] to start the tuning

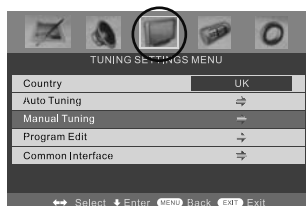

- 5) Press [EXIT] to exit

Safety Warnings

Introducing the LCD TV

Installing the LCD TV

Using The Features

Troubleshooting

Specifications

TV Menu Operation

TUNING SETTINGS MENU

Programme Edit / Changing Channel Position (Only Freeview & Analogue TV modes)
You can change the analogue channel position to suit your requirements.

- 1) Press [MENU] to enter menu
- 2) Press [>] to move to Tuning Settings Menu
- 3) Press [V] to highlight Programme Edit

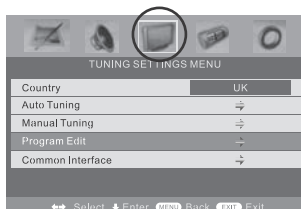

- 4) Press [>] to enter the programme edit menu
- 5a) Freeview mode – Press the [Green] button to add the selected channel to your favorite, press it a second time to remove. Press the [Yellow] to delete the channel from the list. **WARNING** – this will remove the channel complete from the TV. Press [Blue] to lock a channel (to do this the Child Lock function must be set "ON")
- 5b) Analogue TV mode – Press the [>] to select the change you wish to move. Move to the new location and press [OK]

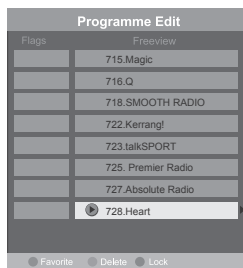

- 6) Press [EXIT] to exit

Common Interface Slot (Only in Freeview Mode)

Pay per view services require a "smartcard" to be inserted into the TV. If you subscribe to a pay per view service the provider will issue you with a 'CAM' card "smartcard". The CAM can then be inserted into the COMMON INTERFACE PORT (see page 8). To access the card follow the steps below.

- 1) Press [MENU] to enter menu
- 2) Press [>] to move to Tuning Settings Menu
- 3) Press [V] to highlight Common Interface
- 4) Press [>] to enter the menu

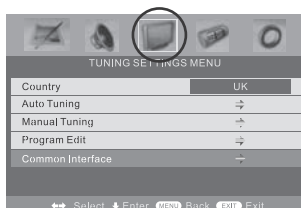

- 5) Press [EXIT] to exit

TV Menu Operation

TIMER SETTINGS MENU

Lets you adjust the OSD timing and the sleep timer

Sleep Timer

Lets you set the sleep timer so the television automatically switches off after a certain amount of time.

- 1) Press [MENU] to enter menu
- 2) Press [→] to move to Timer Settings Menu
- 3) Press [V] to highlight Sleep Timer
- 4) Press [→] to increase the time to the required amount



- 5) Press [EXIT] to exit

On Screen Display Timer

Lets you adjust the amount of time the On Screen Menu stays on the screen before disappearing.

- 1) Press [MENU] to enter menu
- 2) Press [→] to move to Timer Settings Menu
- 3) Press [V] to highlight OSD Timer
- 4) Press [→] to increase the time and [←] to reduce the time



- 5) Press [EXIT] to exit

Safety Warnings

Introducing the LCD TV

Installing the LCD TV

Using The Features

Troubleshooting

Specifications

TV Menu Operation

GENERAL SETTINGS MENU

Lets you adjust the language, picture size, blue screen, add child lock, complete first time installation and reset the television.

On Screen Menu Language

Lets you change the on screen menu language.

- 1) Press [MENU] to enter menu
- 2) Press [>] to move to General Settings Menu
- 3) Press [V] to highlight Language
- 4) Press [>] to change the language

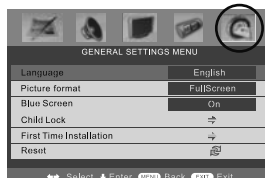

- 5) Press [EXIT] to exit

Picture Format

Lets you adjust the picture format

- 1) Press [MENU] to enter menu
- 2) Press [>] to move to General Settings Menu
- 3) Press [V] to highlight Picture Format
- 4) Press [>] to change the picture format

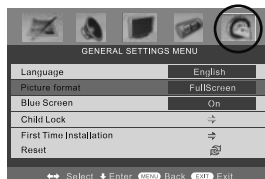

- 5) Press [EXIT] to exit

Blue Screen

Changes the background when there is no input between clear and a blue background

- 1) Press [MENU] to enter menu
- 2) Press [>] to move to General Settings Menu
- 3) Press [V] to highlight Blue Screen
- 4) Press [>] to switch between on and off

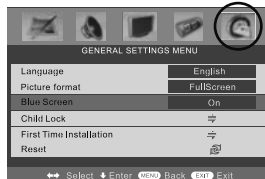

- 5) Press [EXIT] to exit

Child Lock/Key Lock

Allows you to lock certain channels and content so that it can not be viewed by children

- 1) Press [MENU] to enter menu
- 2) Press [>] to move to General Settings Menu

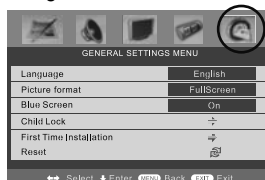

- 3) Press [V] to highlight Child Lock
- 4) To switch on child lock or key lock press [>]

TV Menu Operation

GENERAL SETTINGS MENU

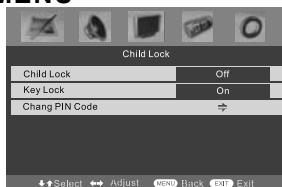

- 5) To change Pin Code enter menu. Enter the old pin code (Default is blank), then enter the new pin code and enter it again. Press [OK], the pin is now changed

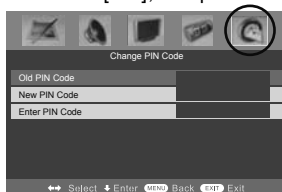

- 6) Press [EXIT] to exit

First Time Installation

Allows you to reset the television for first time tuning.

- 1) Press [MENU] to enter menu
- 2) Press [>] to move to General Settings Menu
- 3) Press [V] to highlight First Time Installation
- 4) Press [OK] and First time install screen will appear

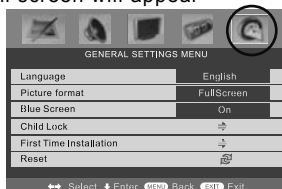

- 5) Press [OK] and tuning will commence.

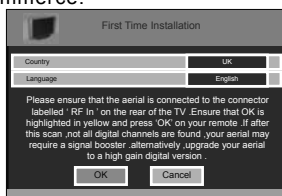

Reset Television

You may wish to reset the menus to factory settings e.g. if you have forgotten a changed password

- 1) Press [MENU] to enter menu
- 2) Press [>] to move to General Settings Menu
- 3) Press [V] to highlight Reset
- 4) Press [OK] to reset the television

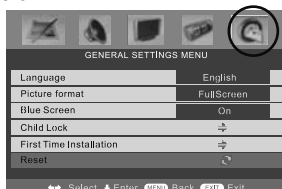

- 5) Press [EXIT] to exit

Safety Warnings

Introducing the LCD TV

Installing the LCD TV

Using The Features

Troubleshooting

Specifications

7 Day TV Guide

7 DAY TV GUIDE

TV Guide is available in Digital TV mode. It provides information about forthcoming programmes (where supported by the broadcasted channel).

You can view the start and end time of all programmes and on all channels for the next 7 days. It is very simple to operate.

1) Press [GUIDE]. The following now and next menu will appear.

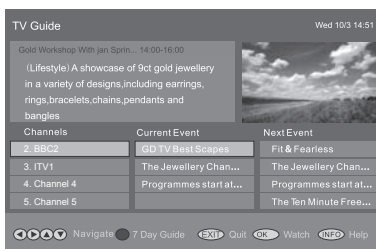

- 2) Navigate through the now and next menu using the [>], [<], [V] and [^] buttons
- 3) Press the [BLUE] button to enter the 7 day menu. Reminders can now be added by pressing [OK].

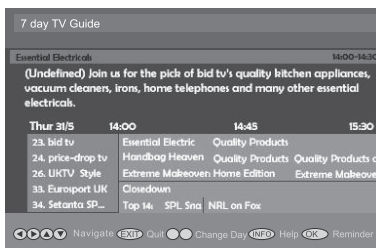

- 4) Press [EXIT] to exit the 7 day TV Guide.

Digital Teletext

Digital TV Teletext

With Digital TV (Freeview) there is also digital teletext available on some channels. Simply follow the on screen commands. Here is an example of the BBC digital teletext service.

- 1) To start digital teletext press the RED button (BBC channels) or the TEXT buttons (Other channels)



- 2) To select the information you require you can scroll using [V] or [^] and press [OK] alternatively you can key the page number for example [3][0][0] followed by [OK]



You can then navigate using the colours buttons (Red, Green, Yellow, Blue), the [^] [V] buttons and numbers.

If you wish to exit at anytime press [EXIT]

Safety Warnings

Introducing the LCD TV

Installing the LCD TV

Using The Features

Troubleshooting

Specifications

TV Mode Teletext Operation

Teletext is a service offered by some broadcasters.

Teletext Operation

1) Press [TEXT], after a few seconds teletext page 100 should appear.

Here is an example of BBC1



2) You can now navigate to the page you require in a number of ways:

- a) Press the page you require using the number buttons i.e. page 302, by pressing [3][0][2]
- b) Press the colour buttons, these will take you to the page indicated on screen for each colour

3) To exit Teletext press [TEXT] twice at any time

Other buttons

[SIZE] this increases or decreases the size of the text on screen

[INDEX] some pages are more than one page long this button displays the number of pages

[REVEAL] if there is an answer or something hidden this will display it

[SUBPAGE] displays the sub page if it exists

[HOLD] This stops the pages changing when there are multiple pages

iPod Operation

Connect iPod to TV-Dock



1. Insert your iPod to the TV-dock on the sound base. The TV will detect the insertion of the iPod and automatically switch to iPod mode. You can also manually switch to iPod mode by pressing **iPOD** button or selecting "iPod" in the source menu.
2. Wait about 3-5 seconds while the screen displays a message "iPod connecting", and then the iPod Menu OSD will appear on the TV screen, and meanwhile the screen of iPod will change to the "OK to Disconnect" picture.

iPod Connecting

If the TV screen continues to display the 'iPod Connecting' message for more than 20 seconds, its because the software/firmware on your iPod is not the latest version as released by Apple. Please refer to the trouble shooting section at the rear of this user guide or visit the helpline web site for details how to upgrade your iPod to the latest version.

- 3) The below menu will appear (This menu comes from the iPod so it may vary based on your settings on your iPod)

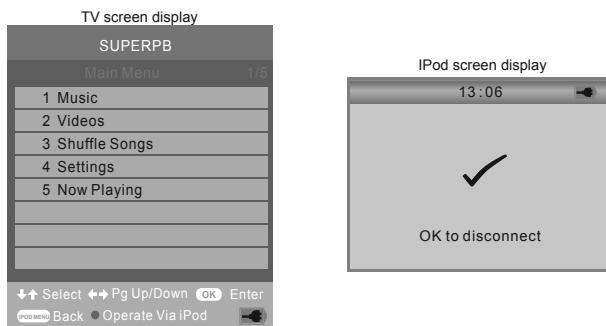

- 4) Press the [RED] button and the menu on the TV will disappear and the iPod Menu will come on



- 5) Using the [^] & [V] you can navigate through the menus and press [OK] to select.



"Made for iPod" means that an electronic accessory has been designed to connect specifically to iPod and has been certified by the developer to meet Apple performance standards.

Apple is not responsible for the operation of this device or its compliance with safety and regulatory standards.

iPod is a trademark of Apple Inc., registered in the U.S. and other countries.

Safety Warnings

Introducing the LCD TV

Installing the LCD TV

Using The Features

Troubleshooting

Specifications

iPod Operation

Key Buttons

VOL-	Decrease the volume
VOL+	Increase the volume
BASS-	Decrease the sub bass
BASS+	Increase the sub bass
▶/	Play/pause
▶▶	Next track
◀◀	Back a track
▶▶▶	Fast forward through current track
◀◀◀	Rewind through current track
■	Stop



Recharge for iPod

iPod is automatically recharged when it is inserted to the TV-dock.



Charged
Charging

Operate the iPod via the screen of iPod

Press RED button to switch to the iPod Control Mode. When in iPod control mode, the iPod menu doesn't appear on the TV screen, but the normal picture appears on the screen of iPod. You can operate iPod via the screen of iPod.

Note:

- You can directly operate iPod or using remote control.
- TV will display a blue blank screen when in iPod control mode.
- When in iPod control mode, press RED button to switch to TV Control Mode

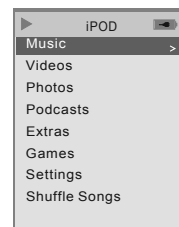

Set Sleep Timer

Press the button on the remote control called 'Sleep' to select the required value (in minutes).

The TV won't switch off automatically when the iPod stop playing. However you can set Sleep Timer to turn the TV off after a period of time.

iPod is a trademark of Apple Inc., registered in the U.S. and other countries.

iPod Operation

Now Playing Interface

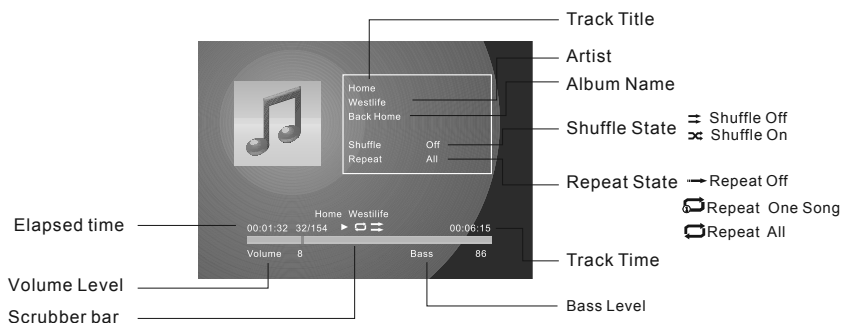

Shuffle and Repeat Songs

Please note - Both the repeat and shuffle mode will default to the iPod settings on the iPod player

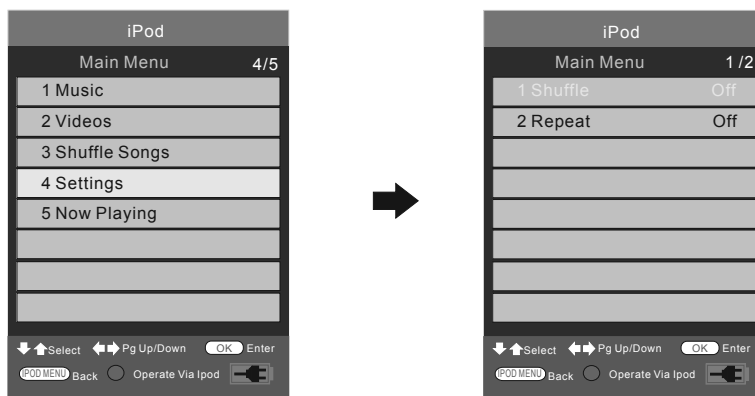

Shuffle Off

iPod is set to play in order

Shuffle Songs

iPod is set to shuffle all the songs in ipod

Shuffle Album

iPod is set to shuffle albums in iPod.

Repeat Off

iPod is not set to repeat songs

Repeat One

iPod play sone song repeatedly

Repeat All

iPod repeats songs in current album or list.

iPod is a trademark of Apple Inc., registered in the U.S. and other countries.

Safety Warnings

Introducing the LCD TV

Installing the LCD TV

Using The Features

Troubleshooting

Specifications

iPod Operation

Watch Videos from iPod

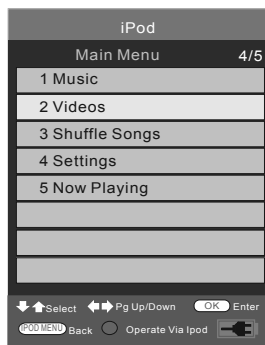

For iPod nano 3Gen, iPod Classic, iPod 5Gen, you can select a video program and play in the iPod Menu OSD.

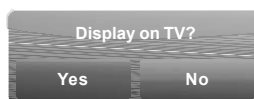

For iPod touch, you can not select videos and play in the iPod Menu OSD, due to the nature of iPod touch. To watch videos, please do as following:

1. Insert the iPod touch to the TV-Dock.
2. Press the Red button to switch to iPod Control Mode.
3. Tap the screen to select video programs and play.
4. When a dialog pops up and ask: "Display On TV?", Please tap the "Yes".

Browse Photos from iPod

To browse photos from iPod

1. Press the Red button to switch to iPod Control Mode
2. For iPod nano 3Gen and iPod Classic, select a photo and press button on the remote control or button on the iPod to start photo slide-show.
3. For iPod photo and iPod 5Gen, you can only press button on the iPod to start photo slide-show.
4. For iPod touch, you can only tap the on the screen to start photo slide-show.

iPod is a trademark of Apple Inc., registered in the U.S. and other countries.

Connecting to a PC - Windows XP

IMPORTANT – Before connecting the computer to the television you must ensure the computer settings are correct for the television. You MUST do this using your old monitor.

WINDOWS XP, WINDOWS VISTA

- 1) Switch on your computer
- 2) When finished booting up right click your mouse anywhere on the screen

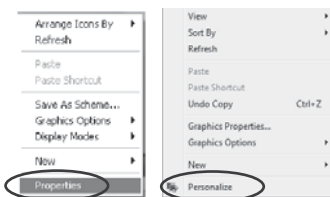

XP Screen

VISTA Screen

- 3) Left click your mouse on Properties/Personalise

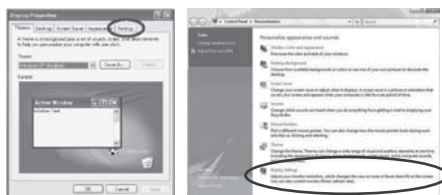

XP Screen

VISTA Screen

- 4) Left click your mouse on Setting/Display Settings. Ensure the screen resolution is set to what is shown in the technical specifications section toward the rear of this user guide. To correct the resolution to that of the television move the slider.



XP Screen

VISTA Screen

Safety Warnings

Introducing the LCD TV

Installing the LCD TV

Using The Features

Troubleshooting

Specifications

Connecting to a PC - Windows XP

5) Left click your mouse on Advance/Advance Settings and left click on Monitor



XP Screen

VISTA Screen

6) Left click on the drop down for Screen refresh rate and select 60 Hertz.

7) Click on Apply, then click Yes and the settings will be saved.

8) Now switch off your computer and connect the television (as shown below)

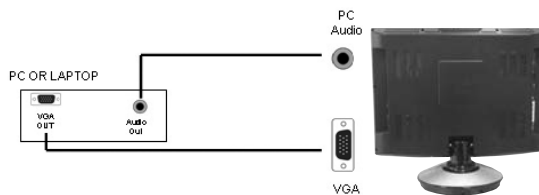

9) Re-start your computer and switch the source to VGA

CONNECTING A LAPTOP

In addition to the above if you are connecting a laptop to the television you will also need to activate the VGA connection on the laptop.

This can vary based on the brand of laptop you have.

1) Connect the laptop to the television

2) On the Laptop push buttons

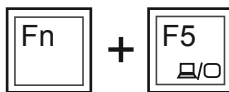

The screen will now switch to the television.

For Windows Vista operating system the process is very similar to the above.
If you require additional support please contact the helpline.

PC Menu Operation (VGA)

VGA MENU

Auto Configuration of Screen

Lets you automatically configure the television to be used as a computer monitor

- 1) Press [MENU] to enter menu
- 2) Press [>] to select PC settings
- 3) Press [V] to select Auto Sync
- 4) Then press [>] for the TV to automatically configure itself

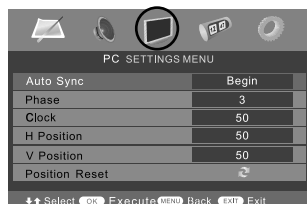

- 5) Press [EXIT] to exit

Phase

To adjust delay time of phase in order to reduce the noise of picture

- 1) Press [MENU] to enter menu
- 2) Press [>] to select PC settings
- 3) Press [V] to select Phase
- 4) Then press [>] or [<] to increase or decrease the phase

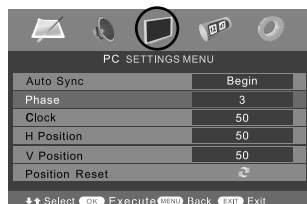

- 5) Press [EXIT] to exit

Clock

Alter this in order to reduce the noise within the picture

- 1) Press [MENU] to enter menu
- 2) Press [>] to select PC settings
- 3) Press [V] to select Clock
- 4) Then press [>] or [<] to increase or decrease the clock

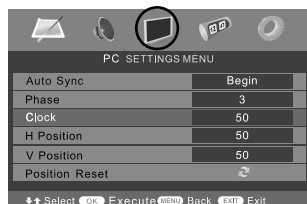

- 5) Press [EXIT] to exit

Safety Warnings

Introducing the LCD TV

Installing the LCD TV

Using The Features

Troubleshooting

Specifications

PC Menu Operation (VGA)

Horizontal Position

Changes the horizontal position of the picture

- 1) Press [MENU] to enter menu
- 2) Press [>] to select PC settings
- 3) Press [V] to select H-Position
- 4) Then press [>] or [<] to move the picture to left or right

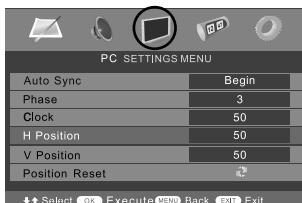

- 5) Press [EXIT] to exit

Vertical Position

Changes the vertical position of the picture

- 1) Press [MENU] to enter menu
- 2) Press [>] to select PC settings
- 3) Press [V] to select V-Position
- 4) Then press [>] or [<] to move the picture up or down



- 5) Press [EXIT] to exit

Position Reset

To position of the picture to the factory settings

- 1) Press [MENU] to enter menu
- 2) Press [>] to select PC settings
- 3) Press [V] to select Position Reset
- 4) Then press [>] or [<] to move the picture up or down

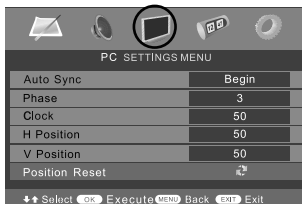

- 5) Press [EXIT] to exit

DVD Menu Operation

HOW TO PLAY DVD'S

The DVD player has an automatic DVD feature which means when you insert a disc it will automatically switch source and start to play.

If you disc does not play please refer to frequently asked questions section of the user guide.

DVD SETTINGS MENU

Adjusting Parental Control

You may wish to block certain DVDs being played, for example if you have young children. This can be done via limiting the age rating of the DVD.

- 1) Press [MENU] to enter menu
- 2) Press [>] to move to DVD Setting Menu
- 3) Press [V] to highlight Parental Control



- 4) Press [>] to enter Parental Control



- 5) Press [<] or [>] to change between the different options
- 6) Press [EXIT] to exit

Safety Warnings

Introducing the LCD TV

Installing the LCD TV

Using The Features

Troubleshooting

Specifications

DVD Menu Operation

Adjusting Language

Lets you adjust the Audio Language, Menu Language, Subtitle Language within DVD mode

- 1) Press [MENU] to enter menu
- 2) Press [>] to move to DVD Setting Menu
- 3) Press [V] to highlight Language

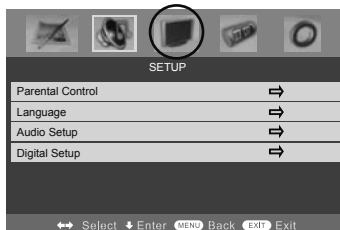

- 4) Press [>] to enter Language

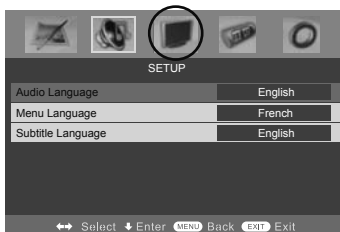

You can now adjust the Audio Language, Menu Language, Subtitle Language within DVD mode

- 5) Press [<] or [>] to change between the different options
- 6) Press [EXIT] to exit

DVD Menu Operation

Adjusting Audio Set Up

Lets you adjust the Audio Setup within DVD mode

- 1) Press [MENU] to enter menu
- 2) Press [>] to move to DVD Setting Menu
- 3) Press [V] to highlight Audio Setup



- 4) Press [>] to enter Audio Setup



You can now adjust the Audio Output from the Coax connection and the Downmix.

Audio Out options:

SPDIF / RAW – Select this option if you are connecting to a Dolby Digital 5.1 surround sounds amplifier via coax cable
 SPDIF / PCM – Select this option if you are connecting to a Stereo Hi-fi via composite video cable

- 5) Press [<] or [>] to change between the different options
- 6) Press [EXIT] to exit

Safety Warnings

Introducing the LCD TV

Installing the LCD TV

Using The Features

Troubleshooting

Specifications

DVD Menu Operation

Adjusting Digital Set Up

Lets you adjust the Audio Setup within DVD mode

- 1) Press [MENU] to enter menu
- 2) Press [>] to move to DVD Setting Menu
- 3) Press [V] to highlight Digital Setup



- 4) Press [>] to enter Digital Setup



You can now adjust the Dynamic Range and Balance.

Dynamic range works only with DVD discs recorded in Dolby digital.

FULL: Set this to listen with the range recorded on the disc.

4/8: Set this to listen with a range equivalent to a normal television.

2/8: Set this to listen with a smaller difference between the maximum and minimum volume.

- 5) Press [<] or [>] to change between the different options
- 6) Press [EXIT] to exit

Changing Regions

This TV/DVD player is pre-set to play Region 2 DVDs. In the event you wish to use the TV/DVD in another country that uses different region discs, please visit www.skymediauk.co.uk.

Select 'product support', 'Changing Region'

Wall Mounting

WARNING

The speakers for this TV are built into the base stand, therefore, the speaker base **cannot** be removed. If you wish to wall mount, only use the screws already provided in the wallmounting holes. Using longer screws could cause damage to internal parts.

THIS TV REQUIRES A CANTILEVER TYPE VESA 100 WALL MOUNT, OR EQUIVALENT



100



To provide improved sound this television has speakers built into the stand of the TV. The stand should therefore not be removed. For best performance the television should be put on a hard flat surface, however if you do wish to wall mount the television this can be done using a cantilever type wall mount.

Wall Mounting the TV.

- 1) Remove the four screws highlighted below.
- 2) The wall mount can now be easily attached to the mounting holes on the rear of the TV. These holes are indicated in the picture below



Safety Warnings

Introducing the LCD TV

Installing the LCD TV

Using The Features

Troubleshooting

Specifications

Using with Sky Digital / Virgin Media

You may wish to use your TV with Sky Digital, Virgin Media or another cable or satellite box.

There are a number of connection options, the best being connecting via SCART cable.

Connecting via SCART

- 1) Connect the SCART cable from the cable/satellite box to the SCART Input on the TV
- 2) Press [SOURCE]
- 3) Press [V] or [^] to select SCART
- 4) Press [OK]

The channel your cable/satellite box is displaying will now be shown on the TV.

You may wish to share your Sky Digital signal around the home by using an RF connection. If this TV is to be connected in this way, please follow the below.

Connecting via RF

Ensure the Sky signal is switched on, before you start the below.

- 1) Connect the RF cable from the RF output socket of the sky/cable box to the 'RF IN' of the TV.
- 2) Switch the TV into analogue TV mode
- 3) Press [MENU] to enter menu.
- 4) Press [>] twice to select Tuning Settings Menu
- 5) Press [V] to select Manual Tuning



- 6) Press [>] to enter Auto tuning
- 7) Press [OK] to start tuning

Once tuning is complete the first channel will appear. Press [CH+] to move through the channel until you find the Sky channel. The channel can then be moved to an alternative position if you wish, please refer to the Program Edit section of the manual.

Using a Sky / Universal Remote Control

USING WITH SKY DIGITAL REMOTE CONTROL (BSKYB) OR UNIVERSAL REMOTE CONTROL

You may wish to use your Sky Digital or a universal remote control to operate some of the functions of this TV. For this you require a 'code' that needs to be programmed into your Sky Digital or universal remote control.

For codes for universal remote controls, please visit our website where you will find the very latest information and codes.

For codes for Sky/Sky+Sky HD, please note that at the point of manufacture, BSkyB have not launched the code required for this model of TV. They are due to launch a new remote control which should include the necessary code to operate the functions of the TV during 2010 (called revision 9).

Please check our website for updates, alternatively, see some alternative options of remote controls that are available.



One for All

Sky Originals

The One for All remote controls shown will operate all of the functions of the Sky box in the same way the original remote control will, in addition, they will also operate the functions of this model of TV. The One for All versions are available to purchase from the helpline/website. The original Sky remote controls are shown for comparison purposes

If you require any further information, you can contact us:

www.skymediauk.co.uk

email - service@skymediauk.co.uk

Tel UK 0871 2000 463 ROI 01443 3940

Safety Warnings

Introducing the LCD TV

Installing the LCD TV

Using The Features

Troubleshooting

Specifications

CONNECTING A GAMES CONSOLE

Connecting a games console can sometimes seem very difficult. We have simplified it to four options depending on the cables that you have.

Option 1 – Connecting via Scart to AV adapter

If you are supplied with a cable from the console which has YELLOW, RED & WHITE connectors you can connect via a SCART to AV adapter (Some console include this)

TV source should be set to SCART.

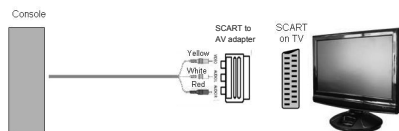

Option 2 - Connecting via Composite Video and Phono cables

If you are supplied with a cable from the console which has YELLOW, RED & WHITE connectors.

TV source should be set to Video

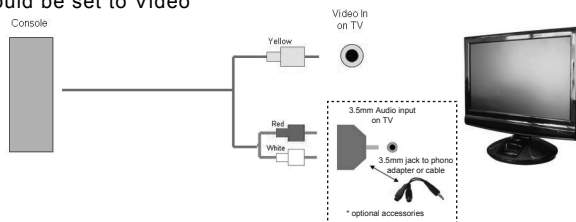

Option 3 – Connecting via HDMI cable

If you are supplied with a HDMI cable this is the easiest option. A HDMI cable can output both video and audio and enables you to enjoy digital-quality video and audio with minimal loss of picture quality.

TV Source should be set to HDMI.

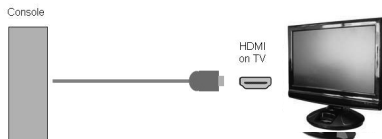

Option 4 – Connecting via Component cable

If you are supplied with a cable from the console which has RED, GREEN, BLUE, RED & WHITE connectors you must connect via Component (for picture) and by 3.5mm to phono cable (for sound).

TV Source should be set to Component.

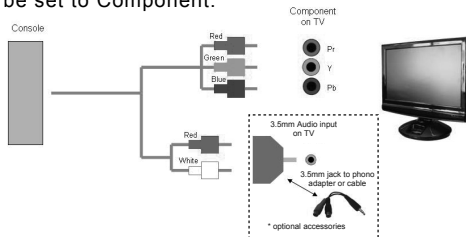

Frequently Asked Questions

Question:	Solution:
I have tuned in Digital TV but I am not receiving any or all of the channels and/or the channels I receive are breaking up	<ol style="list-style-type: none"> 1) Check you are in an area that can receive Freeview. Visit www.freeview.co.uk or call 08701 111 270. 2) Check you are using an aerial that is able to receive a good digital signal. In most cases, you will need an outdoor digital hi-gain/wideband aerial. In areas that have excellent Freeview coverage, you may be able to use a loft type aerial but it is highly likely that you will also need to connect a booster between the back of the TV and the TV aerial wall socket. Unfortunately, to receive a good enough digital signal, it is not possible to use a portable/indoor type aerial. This may change once the analogue signal is switched off in 2012 and the Digital signal strength is increased.
I would like to connect an external amplifier	You require a 3.5mm audio cable to phono (Red & White connections), this can be connected into the rear of the TV stand and to the external amplifier
I have inserted a disc but it is not playing	<ol style="list-style-type: none"> 1) Ensure you have inserted put the disc in facing the correct way forward 2) Ensure the disc is clean and is not scratched 3) Some copied discs will not play. 4) Check the DVD is a region 2 disc – to change the region of the DVD player, refer to section 'Changing Regions'.
I have connected the TV to my VCR via SCART but it is not recording	In addition to connecting via SCART, you should connect the aerial cable from the wall socket to VCR and another aerial cable from the VCR to the TV
I have inserted my iPod but the iPod menu is not being displayed (iPod Connecting remains on screen)	<ol style="list-style-type: none"> 1) Remove the iPod from dock, switch off and then on both the iPod and television in turn. Then re-insert the iPod into the docking station. 2) Update the firmware on the iPod. <ol style="list-style-type: none"> a) Connect your computer to the Internet (if you have broadband, it's probably already connected). b) Connect your iPod to your computer. c) Go to Start All Programs iPod iPod Updater 20xx-xx-xx (it'll have the date Apple released it in the title). d) Run iPod Updater. <p>If you try to update your iPod's firmware and get an error message, chances are that means you need to go to apple.com/ipod/download and get the latest version of the iPod Updater software</p>

Safety Warnings

Introducing the LCD TV

Installing the LCD TV

Using The Features

Troubleshooting

Specifications

Technical Specification

		19" IPOD TV	22" IPOD TV
Panel	Size (Inches)	19"	22"
	Resolution	1440 x 900	1680 x 1050
	Contrast Ratio	1000:1	1000:1
	Brightness cd/m ²	300	300
Input Signal	PC RGB	Yes	
	RF	75 ohm Antenna / PAL-SECAM	
	Video	1 x SCART, 1 x S-Video, 1 x Component (YPbPr - 1080i)	
	Sound	1 x 3.5mm jack for PC audio input, 1 x 3.5mm jack, shared for S-Video & YPbPr (component) audio input	
	HDMI	1 (up to 1080i)	
Speaker Output	Watts (RMS)	2 x 3	
DVD player	DVD	Yes	
Power	Voltage	110-240v 50/60Hz 67W (standby <1W)	110-240v 50/60Hz 72W (standby <1W)
Dimensions	Inc Stand (mm)	470W x 440H x 225D	540W x 480H x 225D
Weight	Net (Kgs)	5,3	6,5

Safety Warnings

Introducing the LCD TV

Installing the LCD TV

Using The Features

Troubleshooting

Specifications

Index

Analogue TV teletext	26	Index	45
Audio Set up	37	Inputs and Connections	12
Auto Configuration of Screen	33	Manual Tuning	19
Auto Tuning	19	On Screen Display Timer	21
Balance	18	On Screen Menu Language	22
Basic iPod Operation	27	Parental Control	35
Bass	18	Phase	33
Blue Screen	22	Picture Format	22
Brightness	14	Picture Mode Preset	13
Browse photos from iPod	30	Position Reset	34
Changing Regions	38	Programme Edit / Changing Channel	
Child Lock	22 - 23	Position	20
Choosing Mode/Source	11	Remote control buttons and their functions	10
Clock	33	Reset Television	23
Colour	14	Sharpness	15
Colour Temperature	16	Shuffle and repeat songs	28
Common Interface Slot	20	Sleep Timer	21
Connecting iPod to TV-dock	27	Sound Mode Preset	17
Connecting to a PC	31 - 32	Technical Specifications	44
Contrast	13	Tint	15
Country	19	Treble	18
Digital Set Up	38	Tuning in TV	9
Digital Switchover Re-Tune	2-3	TV buttons	11
Digital TV teletext	25	Using with Sky Digital / Virgin Media	40
DVD Language	36	Using a Sky / Universal Remote Control	41
Dynamic Noise Reduction	16	Vertical Position	34
7 Day TV Guide	24	Volume	17
First Time Installation	23	Wall mounting the TV	39
Frequently Asked Questions	43	Watch videos from iPod	30
Horizontal Position	34	What is included in the box	8

OPTIONAL ACCESSORIES AND SPARE PARTS

If you need to order replacement parts for your TV, please visit our web site or call the helpline.

If you wish to wall mount your TV, we have a range of fully tested and compatible wall mounts available to order from the helpline or via our web site.

If you wish to purchase a Sky or Sky+ remote control that includes the latest software/codes to operate both your Sky Box as well as this TV, these are available to order from the helpline or web site. Our Sky / Sky+ remote controls operate your Sky or Sky+ box in exactly the same way your current Sky / Sky+ remote does and our versions also look very similar to the Sky equivalent models, albeit slightly smaller in size, they will also operate many of your TV's functions including Power on/off, channel up/down, volume up/down as well as many other functions.



Replacement remote control



Our Sky/Sky+ Remote controls



Cantilever Wall Mount

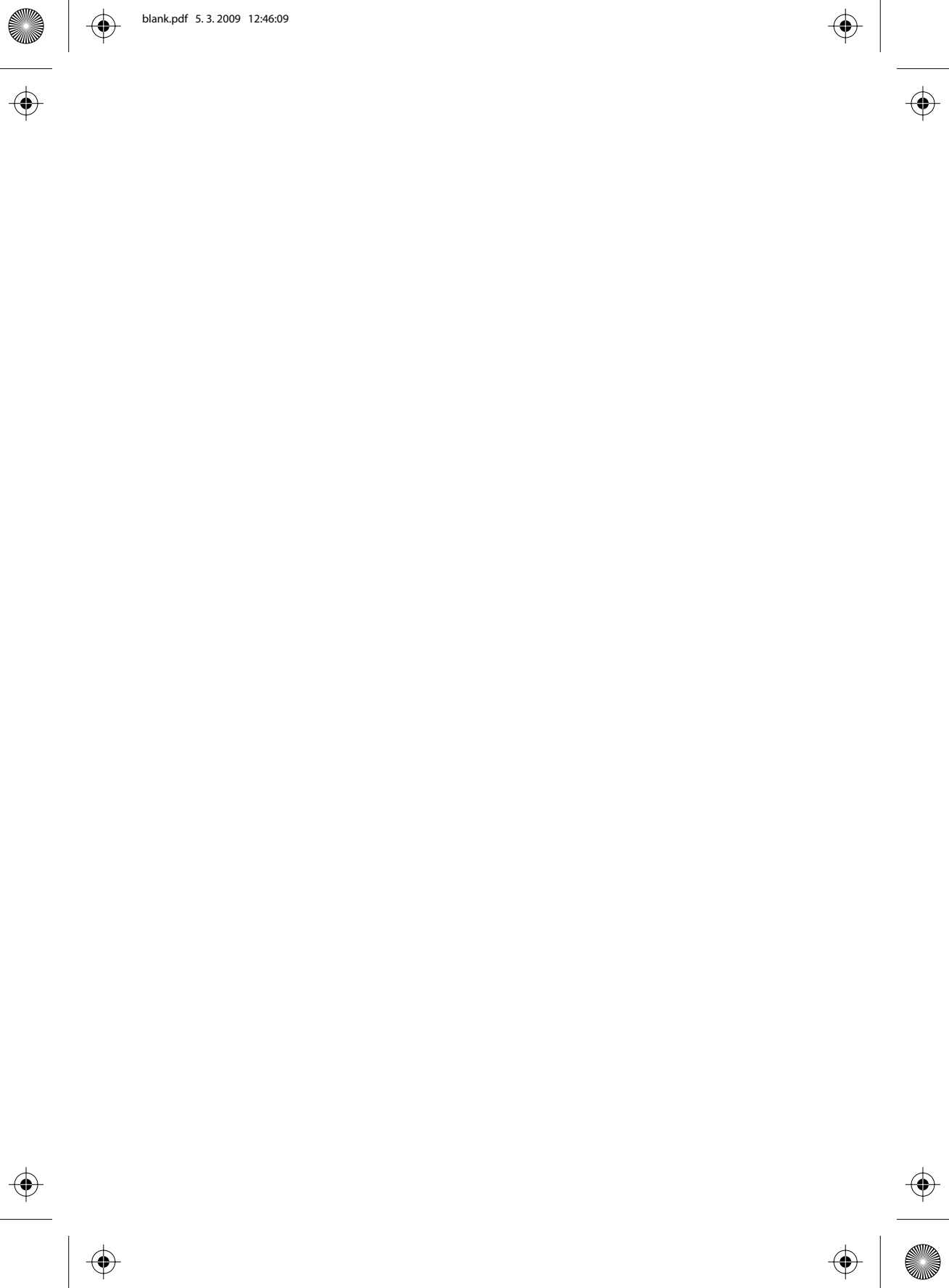

blank.pdf 5. 3. 2009 12:46:09





blank.pdf 5. 3. 2009 12:46:09





TECHNIKA PRO